



BUROSERV

QUICK START GUIDE

14 February 2020

Smart Media Phone

SIP-T56A

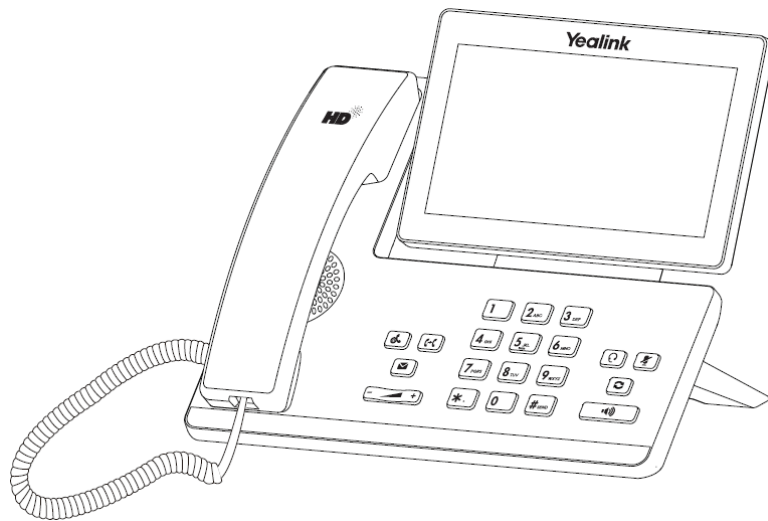

Yealink

Applies to firmware version 58.80.0.10 or later.

Developed by: **BUROSERV Australia**
Level 2, 9 Help Street Chatswood NSW 2067. Australia

Version 1.0

Contents

Packaging Contents	3
Assembling the Phone	4
Hardware Component Instructions	7
StartUp.....	8
Configuring Your Phone.....	8
Configuring via web user interface	8
Configuring via phone user interface.....	9
Using Your Phone	9
Status Icons	9
Using the Touch Screen.....	10
Control Center and Notification Center	10
Entering and Updating Data.....	11
Basic Call Features	12
Placing a Call	12
Answering a Call	12
Ending a Call.....	12
Redial	12
Call Mute and Un-mute.....	12
Call Hold and Resume	12
Call Transfer	13
Call Forward	13
Call Conference	13
Voice Message	14
Customizing Your Phone.....	14
Call History	14
Contact Directory.....	14
Volume Adjustment	14

PACKAGING CONTENTS

The following items are included in your package. If you find anything missing, contact your system administrator:

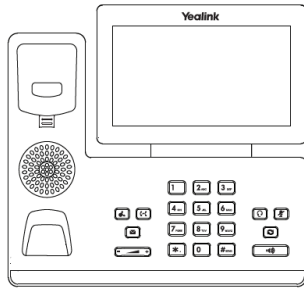

IP Phone



Handset

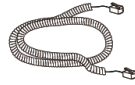

Handset Cord

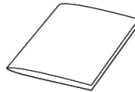

Quick Start Guide



Ethernet Cable
(2m CAT5E FTP cable)

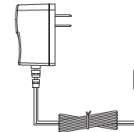

Power Adapter
(Optional)

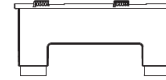

Stand

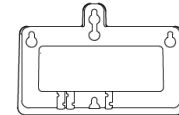

Wall Mount Bracket
(Optional)

Note:

- We recommend that you use the accessories provided or approved by Yealink. The use of unapproved third-party accessories may result in reduced performance.

ASSEMBLING THE PHONE

1. Attach the stand, as shown below:

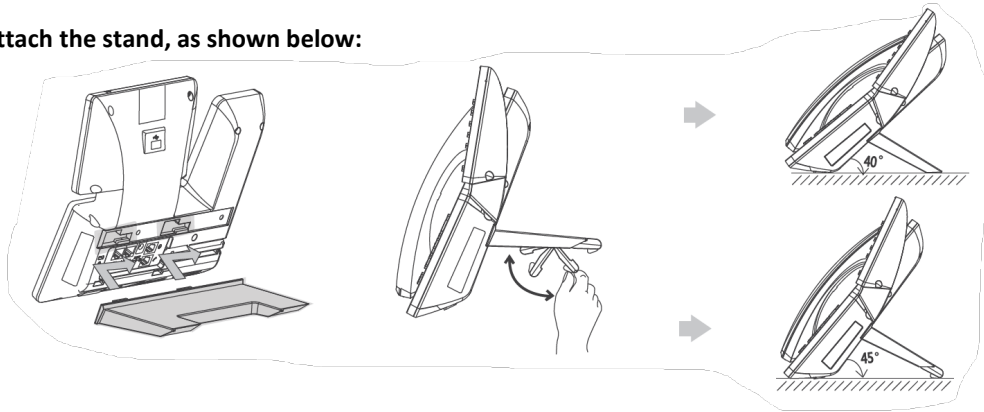

2. Attach the optional wall mount bracket, as shown below:

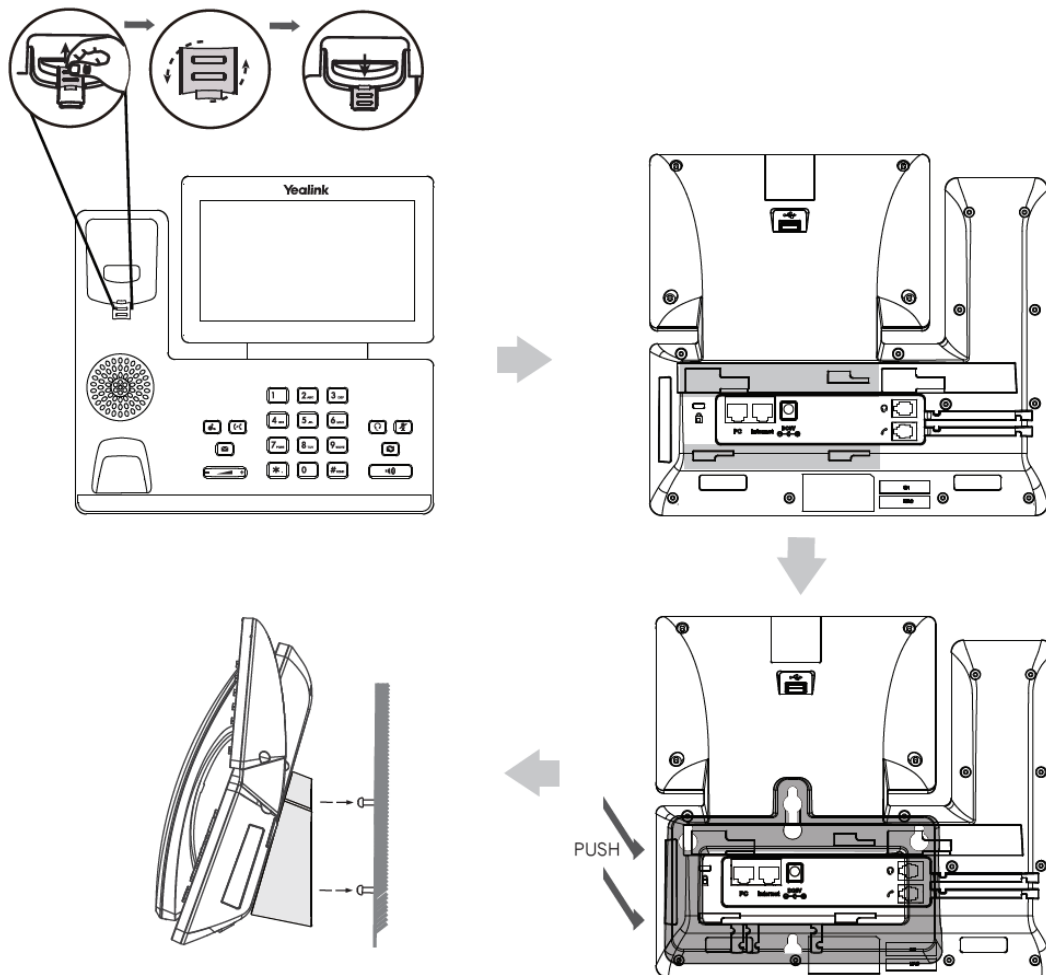

Note:

- The hookswitch tab has a lip that allows the handset to stay on-hook when the IP phone is mounted vertically. For more information, refer to Yealink Wall Mount Quick Installation Guide for Yealink IP Phones.

3. Connect the handset and optional headset, as shown below:

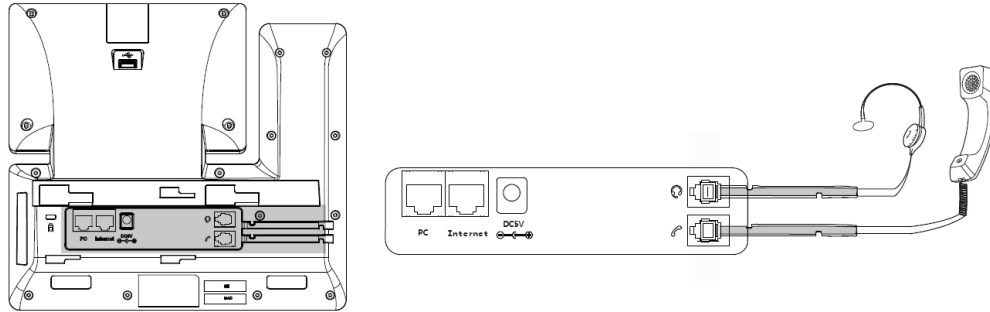

Note:

- The headset should be purchased separately.

4. Connect the optional USB flash drive, as shown below:

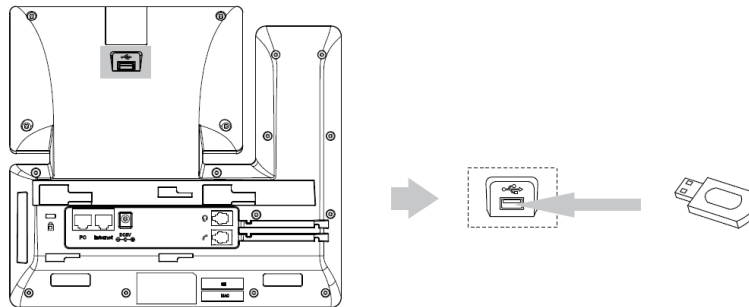

Note:

- The USB port can also be used to connect the color-screen expansion module EXP50 or USB headset. For more information on how to use EXP50, refer to the Yealink EXP50 User Guide. For more information on how to use a USB headset, refer to the documentation from the manufacturer.

5. Connect the AC power or PoE, as shown below:

You have two options for network and power connections. Your system administrator will advise you which one to use.

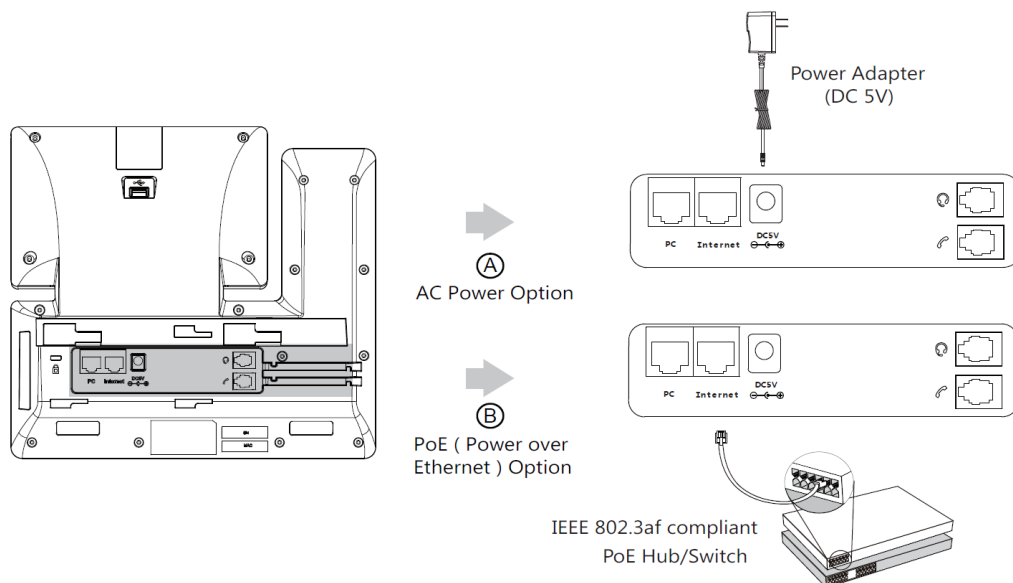

Note:

- The IP phone should be used with Yealink original power adapter (5V/2A) only. The use of the third-party power adapter may cause the damage to the phone.

6. Connect to the network, as shown below:

You have two options for network connection. You can select one of them according to the current office environment.

a) Connect to the wired network:

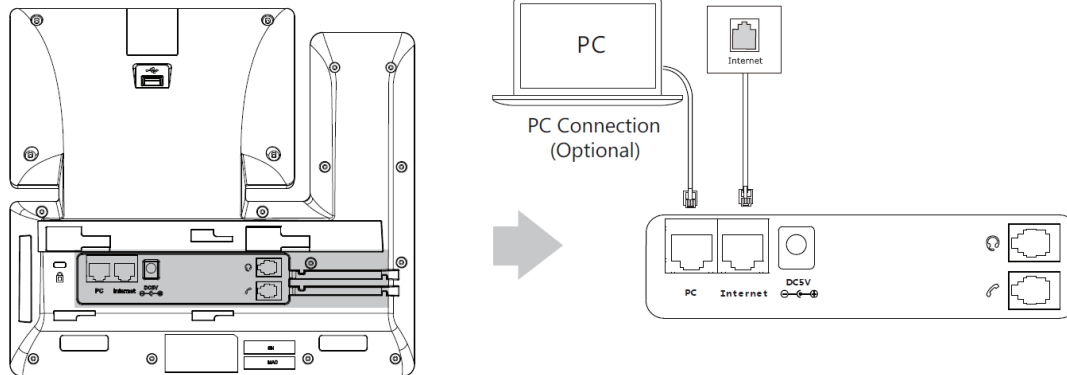
**Note:**

- If you are connecting a PC to your phone, we recommend that you use the Ethernet cable provided by Yealink.

b) Connect to the wireless network:

- 1) Swipe down from the top of the screen to enter the control center.
- 2) Tap **Settings->Basic->Wi-Fi**.
- 3) Tap the **On** radio box in the **Wi-Fi** field.
The phone will automatically search for available wireless networks in your area.
- 4) Select an available wireless network from the list of networks.
- 5) If the network is secure, enter its password in the **Password** field.
- 6) Tap **Connect** to connect to the wireless network.

HARDWARE COMPONENT INSTRUCTIONS

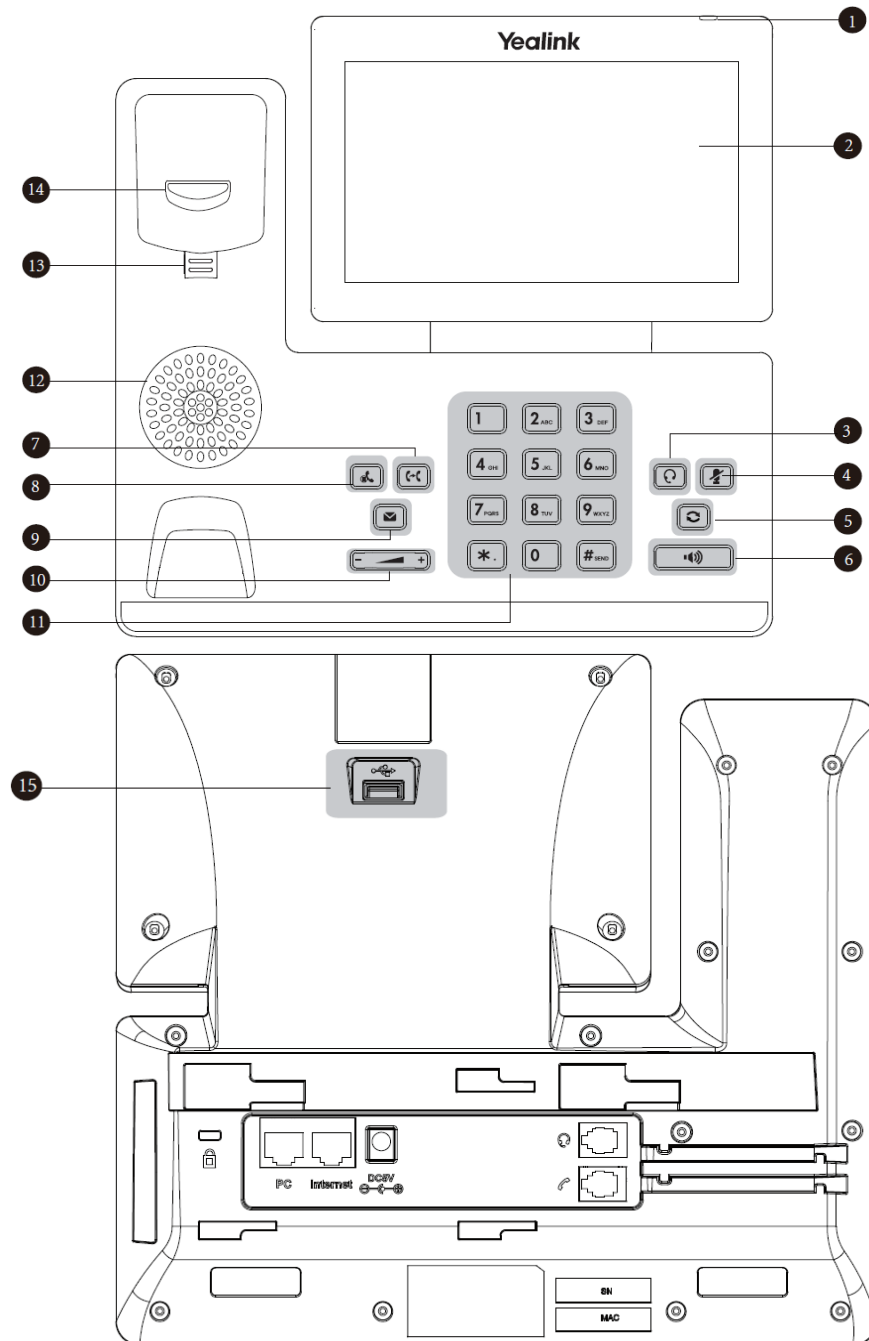

Item	Item	Item
1 Power Indicator LED	6 Speakerphone Key	11 Keypad
2 Touch Screen	7 TRANSFER Key	12 Speaker
3 HEADSET Key	8 HOLD Key	13 Hookswitch Tab
4 MUTE Key	9 MESSAGE Key	14 Hookswitch
5 REDIAL Key	10 Volume Key	15 USB2.0 port

STARTUP

After the IP phone is connected to the network and supplied with power, it automatically begins the initialization process. After startup, the phone is ready for use. You can configure the phone via web user interface or phone user interface.

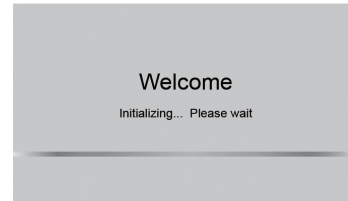

CONFIGURING YOUR PHONE

CONFIGURING VIA WEB USER INTERFACE

Accessing the web user interface:

1. Swipe down from the top of the screen to enter the control center.
2. Tap **Settings**->**Status** to obtain the IP address of the phone.
3. Open a web browser on your computer, enter the IP address into the address bar (e.g., "http://192.168.0.10" or "192.168.0.10"), and then press the **Enter**.
4. Enter the user name (default: admin) and password (default: admin) in the login page and click **Confirm**.

Network Settings: Click on **Network**->**Basic**->**IPv4 Config**

You can configure the network settings in the following ways:

DHCP: By default, the phone attempts to contact a DHCP server in your network to obtain its valid network settings, e.g., IP address, subnet mask, gateway address, and DNS address.

Static IP Address: If the phone cannot contact a DHCP server for any reason, you need to configure IP address, subnet mask, gateway address, primary DNS address and secondary DNS address for the phone manually.

PPPoE: If you are using an xDSL modem, you can connect your phone to the Internet via PPPoE mode. Contact the ITSP for the PPPoE user name and password.

Note:

- The IP phone also supports IPv6, but IPv6 is disabled by default.
- The wrong network settings may result in inaccessibility of the phone and may have an impact on network performance. Contact your system administrator for more information.

Account Settings: Click on **Account**->**Register**->**Account X (X=1,2,3...15,16)**

Parameters of the account:

Register Status:	It shows the register status of the current account.
Line Active:	You can select Enabled/Disabled to enable/disable the account.
Label:	It is shown on the touch screen to identify the account.
Display Name:	It is shown as Caller ID when placing a call.
Register Name:	It is an authenticated ID for authentication provided by ITSP (required).
User Name:	It is provided by ITSP for registration (required).
Password:	It is provided by ITSP for registration (required).
Server Host:	It is provided by ITSP for registration (required).

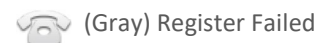
Register status icons on the LCD screen:**Note:**

- Check with your system administrator if any error appears during the registration process or a specific the configuration is required for your registration.

CONFIGURING VIA PHONE USER INTERFACE**Configuring Network Settings:**

1. Swipe down from the top of the screen to enter the control center.
2. Tap **Settings->Advanced** (default password: admin)->**Network->WAN Port/VLAN/Webserver Type/802.1x/VPN/LLDP/CDP/NAT** to configure the network.

Account Settings:

1. Swipe down from the top of the screen to enter the control center.
2. Tap **Settings->Advanced** (default password: admin)->**Accounts** to configure the account.

USING YOUR PHONE**STATUS ICONS**

The icons on the status bar of the touch screen give information about the phone:



Icons	Description
(White)	Shows that Wi-Fi is turned on.
(Green)	Shows that the phone is connected to wireless network successfully.
	Shows that wired network is unavailable.
(White)	Shows that Bluetooth is turned on.
(Green)	Shows that Bluetooth headset is paired successfully.
(Green)	Shows that Bluetooth-Enabled mobile phone is paired successfully.
	Shows that the phone is locked.
	Shows that "Forward" is turned on.
	Shows that "Do Not Disturb" is turned on.
	Shows that "Auto Answer" is turned on.
	Shows that you have missed calls.
	Shows that you have unread voice mails.
	Shows that "Silent" is turned on.
	Shows that a USB flash drive is detected.

USING THE TOUCH SCREEN

By default, the IP phone supports three idle screens. The home screen displays as below:



To navigate the touch screen:

- Swipe left or right to switch among different idle screens.
- Tap  to go back to the previous screen.
- Tap  to go back to the previous screen.
- Tap  to go back to the previous screen.

To change the wallpaper:

1. Long tap the empty spot on the idle screen.
2. Tap **WALLPAPERS**.
3. Select the desired picture.
4. Tap **Set wallpaper**.

To add a widget to the idle screen:

1. Long tap the empty spot on the idle screen.
2. Tap **WIDGETS**.
3. Drag the desired widget up/down/left/right to the destination spot on the idle screen.

CONTROL CENTER AND NOTIFICATION CENTER

Swipe down from the top of the screen to enter the control center and the notification center.

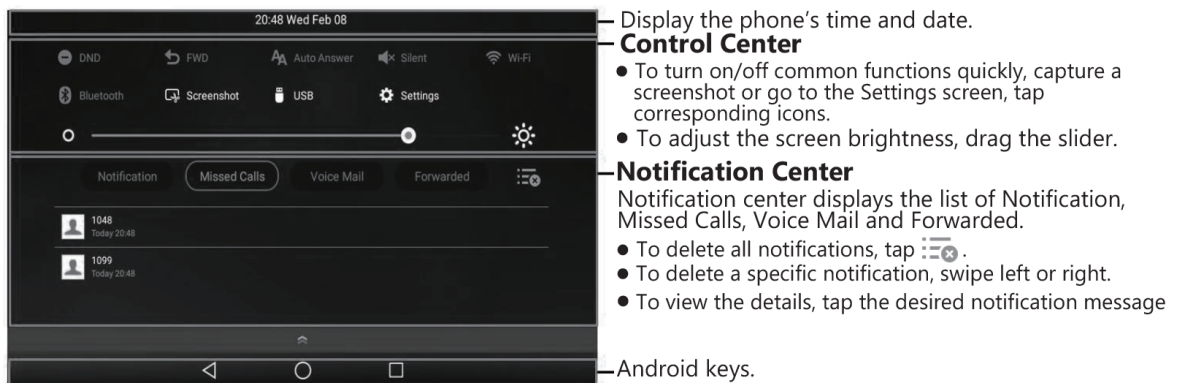

Display the phone's time and date.

Control Center

- To turn on/off common functions quickly, capture a screenshot or go to the Settings screen, tap corresponding icons.
- To adjust the screen brightness, drag the slider.

Notification Center

Notification center displays the list of Notification, Missed Calls, Voice Mail and Forwarded.

- To delete all notifications, tap .
- To delete a specific notification, swipe left or right.
- To view the details, tap the desired notification message

Android keys.

Swipe up from the bottom of the screen to hide this screen.

ENTERING AND UPDATING DATA

To use the on-screen keyboard:

1. Tap the input field, the onscreen keyboard will display on the touch screen:



Tap to access input options to configure Input Languages or Android Keyboard Settings(AOSP).

2. When you finish entering, tap  to hide the onscreen keyboard.

To use keypad:

Dial or enter number.

To select a field option:

Tap the field name, tap the desired option in the pop-up dialog box.

BASIC CALL FEATURES

PLACING A CALL

Using the handset:

1. Pick up the handset.
2. Enter the number, and then tap **Send**.

Using the speakerphone:

1. With the handset on-hook, press .
2. Enter the number, and then tap **Send**.

Using the headset:

1. With the headset connected, press  to activate the headset mode.
2. Enter the number, and then tap **Send**.

Note:

- During a call, you can alternate between the headset, hands-free speakerphone and handset modes by pressing **Reject**, pressing the **HEADSET** key, the **Speakerphone** key or by picking up the handset. Headset mode requires a connected headset.

ANSWERING A CALL

Using the handset:

Pick up the handset.

Using the speakerphone:

Press .

Using the headset:

Press .

ENDING A CALL

Using the handset:

Hang up the handset or tap the **EndCall** soft key.



Using the speakerphone:

Press  or **EndCall**.



Using the headset:

Tap the **EndCall** soft key.

REDIAL

- Press  to enter the **Placed Calls** list, and then tap the desired entry.
- Press  twice when the phone is idle to dial out the last dialed number.

CALL MUTE AND UN-MUTE



- Press  to mute the microphone during a call.
- Press  again to un-mute the call.

CALL HOLD AND RESUME

To place a call on hold:

Press  or tap the **Hold** soft key during an active call.



To Resume the call, do one of the following:

- If there is only one call on hold, press  or tap the **Resume** soft key.
- If there is more than one call on hold, tap the call you want to resume, and press  or tap the **Resume** soft key.



CALL TRANSFER

You can transfer a call in the following ways:



Blind Transfer

1. Press  or tap the **Transfer** soft key during an active call. The call is placed on hold.
2. Enter the number you want to transfer to.
3. Press .

Semi-Attended Transfer

1. Press  or tap the **Transfer** soft key during an active call. The call is placed on hold.
2. Enter the number you want to transfer to, and then press .
3. Press  or tap the **Transfer** soft key when you hear the ring-back tone.

Attended Transfer

1. Press  or **Transfer** soft key during an active call. The call is placed on hold.
2. Enter the number you want to transfer to, and then press .
3. Press  or **Transfer** soft key when the second party answers.

CALL FORWARD**To enable call forward:**

1. Swipe down from the top of the screen to enter the control center.
2. Tap **Settings->Features->Call Forward**.
3. Select the desired forward type:
 - Always Forward**----Incoming calls are forwarded unconditionally.
 - Busy Forward**----Incoming calls are forwarded when the phone is busy.
 - No Answer Forward**----Incoming calls are forwarded if not answered after a period of time.
4. Enter the number you want to forward to. For **No Answer Forward**, tap the **After Ring Time field**, and then tap the desired ring time to wait before forwarding.
5. Tap  to accept the change.

CALL CONFERENCE

1. Tap the **Conference** soft key during an active call. The call is placed on hold.
2. Enter the number of the second party, and then press  or tap **Conference**.
3. Tap the **Conference** soft key again when the second party answers. All parties are now joined in the conference.
4. Tap the **End Call** soft key to disconnect all parties.

Note:

- You can split the conference call into two individual calls by tapping the **Split** soft key.

VOICE MESSAGE



Message waiting indicator on the idle screen indicates that one or more voicemail messages are waiting at the message center. The power indicator LED slowly flashes red.

To listen to voice messages:

- Do one of the following:
 - Press .
 - Swipe down from the top of the screen to enter the notification center, tap Voice Mail and then select the desired item.
- Follow the voice prompts to listen to your voicemail messages.



CUSTOMIZING YOUR PHONE

CALL HISTORY



- Tap , and then select the desired call list on the left.
- Drag up and down to scroll.
- Tap  after the desired entry, and then you can do the following:
 - Tap **Send** to place a call.
 - Tap **Add** to add the entry to the local directory.
 - Tap **Edit** to edit the phone number of the entry before placing a call.
 - Tap **Blacklist** to add the entry to the blacklist.
 - Tap **Delete** to delete the entry from the list.

CONTACT DIRECTORY



To add a contact:

- Tap , and then select the desired group on the left.
- Tap  to add a contact.
- Enter a unique contact name in the **Name** field and contact numbers in the corresponding fields.
- Tap  to accept the change.

To edit a contact:

- Tap , and then select the desired group on the left.
- Tap  after the desired contact.
- Edit the contact information.
- Tap  to accept the change.



To delete a contact:

- Tap , and then select the desired group on the left.
- Tap  after the desired contact and then tap **Delete**.
- Press **OK** when the LCD screen prompts “Delete selected item?”.

Note:

- You can add contacts from call history easily. For more information, refer to **Call History** above.

VOLUME ADJUSTMENT

- Press  during a call to adjust the receiver volume of the handset/speakerphone/headset.
- Press  when the phone is idle or ringing to adjust the ringer volume.
- Press  to adjust the media volume on the corresponding screen.

About us

Founded in 2001, Yealink, a leading provider of VoIP Phone and IP communication solutions, has been focusing on VoIP products characterized by reliable quality, easy deployment and affordable price for more than a decade. Today, customers from over 140 countries rely on Yealink as the backbone of global collaboration to extend the value of network communications.

More about Yealink

Since 2001, Yealink has continued to develop state-of-the-art, hi-tech VoIP communication terminals that include IP video phones, IP phones, and USB phones. With a worldwide market in more than 140 countries, the company has also established a first-class international service network.

Our priorities are quality, functionality, ease-of-use, customer support, and competitive pricing. To provide new solutions for the future in this fast-evolving sector, Yealink's large, talented and highly-experienced VoIP R&D team is totally committed to the pursuit of excellence.

To date, we have passed more than 80 interoperability tests and meet certification requirements set by leading VoIP systems and platforms. Yealink works in close partnership with T-Mobile, Telefonica, Portugal Telecom and other leading telecommunication service providers.



YEALINK(XIAMEN) NETWORK TECHNOLOGY CO.,LTD.
Web: www.yealink.com
Addr: 309, 3th Floor, No.16, Yun Ding North Road, Huli
District, Xiamen City, Fujian, P.R. China
Copyright©2016Yealink Inc.All right reserved.